

## PARTICULARS OF

### RIVA 59 MERCURIUS SUPER

## EMILIE



<b>LOA:</b>	<b>18.58M</b>
<b>Year:</b>	<b>2005</b>
<b>Beam:</b>	<b>4.72M</b>
<b>Draft:</b>	<b>1.6M</b>
<b>Model:</b>	<b>MERCURIUS SUPER 59</b>
<b>Hull Material:</b>	<b>GRP</b>
<b>Layout:</b>	<b>Three double/twin guest cabins plus captain</b>
<b>Engines:</b>	<b>Twin MAN, (1300hp) diesel</b>
<b>Hull Designer:</b>	<b>Riva</b>
<b>Flag / Class:</b>	<b>British - CE Cat A 10 people</b>
<b>Location:</b>	<b>South of France</b>
<b>Price:</b>	<b>€ 580.000 Euros VAT Paid in Europe</b>

## **EMILIE Continued.....**

### **Summary**

EMILY has to be the finest Riva 59 ever built and certainly the best to ever come on the market. The owner has maintained her to an exceptional standard and when he purchased her in 2016 the refit and upgrades were both cosmetic and mechanical resulting in the lovely combination of Classic lines with modern comforts and finish that you would find on a new boat costing several million Euros.

She has wintered out of the water since 2016 in covered storage which is a perfect example of how this owner like to take care of his Riva.

A unique opportunity for a buyer who has discerning taste and style.

### **Principal Features**

Three guest cabins with two heads  
Zero Speed stabilization - Seakeeper 9  
Captain cabin fit out  
Fully air conditioned

Engines recent large works  
New teak decks 2016  
Hydraulic Passerelle  
Tender garage for Tender & toys

### **Construction**

Hull: GRP – modified deep V with spray rails. Hand laid glassfibre construction with isophthalic gel coat backed by initial lay-up of powder bound matt and isophthalic resin. Tops sides painted by Navy blue AWL Grip 2016. Gold and Maroon Boot top, Black antifouling. All antifouling removed 2020, gel shield applied, primer and fresh paint.

Side Deck: GRP – with Teak laid decks 2016. Depth 12 MM

Superstructure: GRP Off white

Cockpit/Bathing Platform: GRP – New Teak laid decks 2016, Depth 12 MM

**Interior Colours:** Furniture finished in natural satin oak complemented with layered wood work in navy blue and white. White leather inserts and panels complement with mirrored door finishes and stainless steel surrounds. Stunning Riva table white and blue lacquer.

Cream leather saloon upholstery. Saloon and cabin floors limed oak floor boards and white bound carpet overlays. Heads finished with teak grating inserts, white marble tops and cream GRP mouldings. Galley work top and lower cupboard fronts are white lacquer. Fully spec and swatches of interior are with the boats files and available – All internal finished and soft furnishings were replaced in 2016.

**External:** Helm console painted in navy blue with high gloss finish and Carbon effect inserts. Cockpit Upholstery is Cream, new 2016, including Foredeck sun cushions Further external upholstery updates in 2019 and 2022. All sun pads have removable white towelling covers. External wood work is solid teak and high gloss varnish in impeccable condition.

### **Mechanical**

Engines: 2x MAN D2842 LE 404, 8 cylinder V configuration 1300 HP @2300 RPM diesel

Both engines had new Turbos in 2024

Both engines have a full service history from MAN specialist

## **EMILIE Continued.....**

All cooling systems including gear boxes were cleaned in 2024  
ZR gear boxes on a shaft drive V drive  
Water lubricated stern glands  
Rudder angle indicator  
Speed Max: 38 knots (depending on conditions)  
Cruising speed: 25-30knots  
Approx engine hours: 2000  
Consumption: cruising 12 lit per mile @ 25 Knots  
Range approximately 300 miles (inc 500 lit unusable)  
Hydraulic powered steering  
Single lever MAN electronic engine controls  
Thruster: Side-power bow thruster SP95  
Hydraulic Trim tabs with indicators  
Alarm systems: bilge alarm audible and warning lights  
3 Electric bilge pumps, automatic  
Hand-held extinguishers in cabins, Auto-extinguishers in engine room Seafire FM200  
Engine room fans  
Automatic and manual bilge pump systems  
Four bladed propellers

### **Electrical**

1 bank of 4 x 24 volt heavy duty batteries for engine starting - 2022  
1 bank of 4 x 24 volt heavy duty batteries for domestic use - 2023  
1 bank of 1 x 12 volt heavy duty battery for Generator (2021)  
Shore power system: 240 volts shore power supply to all cabins  
Polarity check system  
Circuit breakers on all circuits  
12v dropper for certain navigation and radio circuits  
Mastervolt Ultra Mass sine wave 24/4000 inverter for domestic 220v use

### **Charging**

Kohler 13 Kva generator 13.5EFK020, 1000 hours - new 2021  
2 Engine alternators charge via blocking diodes to isolate engine start batteries from auxiliaries  
Dolphin 24v 80 Ah Float battery charger  
Separate 12v charger for generator battery

### **Water systems**

Hot water production: 240volt immersion and hot water calorifier  
Pressurised hot and cold water system  
Water level gauge, Deck filler  
Idromar water maker – regularly serviced – Produces 150 lit per hour

### **Tankage**

Fuel: 770 Gallons, 3,500 Litres, 1 stainless steel Tank with sight gauge

## **EMILIE Continued.....**

2 Racor 1002FH primary fuel filters  
Water: 153 gallons, 700 litres, 2 Tanks plus 16 gallons hot water  
Holding tanks with sea and deck pump out  
Grey water tanks with sea and deck pump out

### **Navigation Equipment**

Simrad	NSS EVO2 Chart plotter – with remote button controls
Simrad	Multi display – Speed/depth/wind/position/compass
Simrad	Broadband 4G Radar Scanner
Simrad	AP70 autopilot
Simrad	HS90 VHF - DSC
Simrad	GPS
Simrad	Compass
Simrad	NAIS 400 Class B unit
Furuno	Multifunction display in Captains cabin

### **Deck equipment**

Reversible electric Quick anchor winch with Capstan, foredeck and helm control  
35kg Stainless Bruce anchor and 90m of 10mm chain feeding through Riva custom stainless bow roller and bow protection plate  
Danforth kedge anchor  
Fore deck wash and fore deck locker  
Full set of IMCO navigation lights  
Stainless steel Riva bow, stern and midships spring cleats in pairs  
Searchlight with remote control on Arch -Sanshin HR-55  
Electric horn  
Besenzoni hydraulic passerelle with remote control, doubles as dinghy lift, serviced 2024  
Foredeck sunbathing cushions with teak surround and integrated oddments tray and cup holders  
Stern Quarter capstan winch on starboard side for mooring lines -Lofrans  
Liferafts Crewsaver 12 Man (2015) Serviced 2024  
Hydraulic Swimming ladder out of platform with teak treads  
Individual Covers, for cockpit table and helm seating  
Integrated Bimini folding out of Radar Arch for storage with additional side shades  
Bathing platform shower  
Cockpit over head radar arch and low level lighting on all steps and stairs too - dimable  
Cockpit speakers – Four Fusion  
Inflatable light weight tender 2.1m Mercury worth 2.5hp four stroke Yamaha outboard motor  
Large teak folding cockpit table, seats up to 10 with 2 folding chairs  
Cockpit fridges are integrated behind the helm position and there are three all top loading and all approx 50 lit each

### **Accommodation**

## EMILIE Continued.....

3-cabin layout: A midships double cabin with en suit heads and shower complements the forward double which is also en-suit. To starboard is a comfortable twin cabin with bunk beds. Captains cabin accessed from the cockpit.

See Layout:

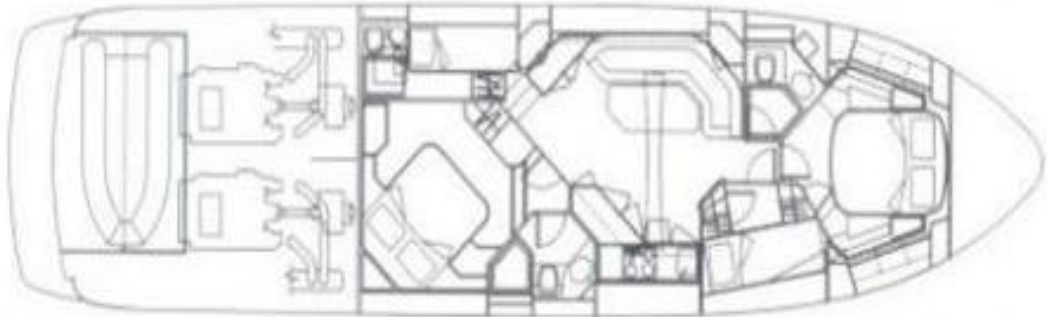

### Forecabin/VIP:

Large double bed; hanging locker; cupboard with shelves; draws below the bed; opening portholes and opening over head hatch. Reading lights, individual sounds system.

Shower/WC; washbasin; shower screens which swing out with automatic pump-out; extractor fan; shaver point. Electric heads.

### Starboard guest cabin:

2 single berths in bunk bed style; hanging lockers and shelves. Individual berth lights. Opening porthole. Shares heads with VIP Cabin, easily accessed.

### Midships Owners Double cabin:

Large double berth, twin bedside tables and lamps, storage all round, dressing table with large mirror. Hanging wardrobe and draws. Independent CD/Radio. En-suit heads with wash basin and separate shower compartment. Useful storage lockers; extractor fan; shaver point.

### Saloon:

L shaped sofa and main table to Port finished in cream textured leather. Table with stunning blue and white lacquer finish which can comfortably seat six. Good size hull windows allow plenty of natural light in. Over head light allows natural light into the salon and is incorporated into deck head (re-sealed 2024). General entertainments centre also to port including the Bose Lifestyle system - DVD/CD sound system. Ample crockery storage, glass storage with cutouts and custom cutlery draw with individual placement.

### Galley:

To starboard and incorporated into the saloon thanks to the same white lacquer finish and cupboard fronts. Fold back tops reveal the Corian sink and drainer and the 4-Ring electric hob, combination oven microwave, and grill are found overhead. Two large custom 24v/240v fridge and/or freezer are in the galley. Half size Bosch Dish washer is under counter.

## EMILIE Continued.....

### Domestic Equipment

Condaria air handling / Dometic (ER coolers new 2021)- Air conditioning/reverse cycle to all cabins inc captains cabin

Sharp combination oven, microwave & grill

Bosch 4 ring electric hob with fiddles

Bosch half size dish washer

2 x Frigo Nautica custom stainless steel 24/240v refrigerators two size, approx 100 and 50 lit.

3 x Cockpit fridges, all top loading with cold plates, approx 50 lit each.

Heads: Techma quiet Electric flush

Bose Lifestyle Amplifier powering surround sound system, multiple surround sound speakers and subwoofer below saloon seating

TCL Flat screen TV integrate into joinery above galley work top

Individual sound systems in cabins – Car radio style Sony and Blaupunkt

House hold equipment: Glasses, china and cutlery, inc Riva China originally supplied.

**Items on board but not included in sale.** Personal belongings and owner equipment not expressly listed above. All photos on walls.

#### **Disclaimer**

*These particulars have been prepared from information provided by the vendors and are intended as a general guide to the yacht, their accuracy cannot be guaranteed by us. The purchaser should confirm details of concern to them by survey or engineer's inspection. The purchaser should also ensure that the purchase contract properly reflects their concerns and specifies details on which they may wish to rely.*